

● 4BPA



MEDIUM 4 PISTON FORGED CALIPER

中對 4 活塞鍛造卡鉗(4BPA#210)

TECHNICAL SPECIFICATION

| | | | |
|-------------------|--|------------------|-----------------------|
| Piston Size | $\phi 38.18\text{mm} * 2 + \phi 42.85\text{mm} * 2 ; \phi 33.96\text{mm} * 4(\text{REAR})$ | | |
| Piston Area | $25.86\text{cm}^2 * 2 ; 18.1\text{cm}^2 * 2 (\text{REAR})$ | 'PL' Dimension | 51 mm |
| Piston Material | Aluminum Alloy | Caliper Body | 2 pieces |
| Disc Diameter | ϕB | Caliper Material | Aluminum Alloy Forged |
| Disc Thicknesses | T:30mm(T28~T32mm) | | |
| Weight(Less Pads) | 2.83kg | | |
| Hydraulic Threads | M10*1.0 | | |
| Mounting | Radial | | |
| centres | 130mm | | |
| offset | F mm | | |
| hole ϕ | 12.2mm | | |



PAD FAMILY(HF4BPA)

Pad Area=62.9cm²
 Pad Depth=48.8mm
 Pad Thickness=15mm(with shim, panel thicknes 5.5mm)
 Pad Weight =0.87kg(2pieces)

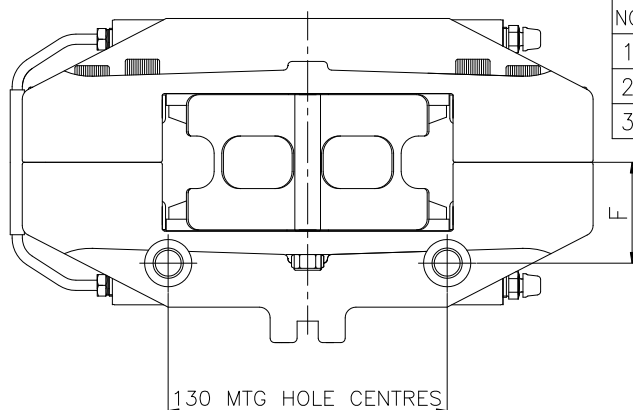
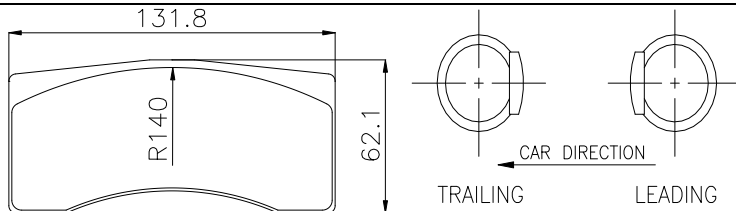

| NO | DISC $\phi B/T$ | ϕA | ϕB | ϕC | ϕD | E | F | G | H |
|----|-----------------|----------|----------|----------|----------|-------|----|----|-----|
| 1 | $\phi 330/30$ | 379.52 | 330 | 275.08 | 219.08 | 113 | 47 | 94 | 114 |
| 2 | $\phi 355/30$ | 398.42 | 355 | 299.49 | 243.49 | 125.5 | 47 | 94 | 114 |
| 3 | $\phi 380/30$ | 418 | 380 | 323.99 | 267.99 | 138 | 47 | 94 | 114 |

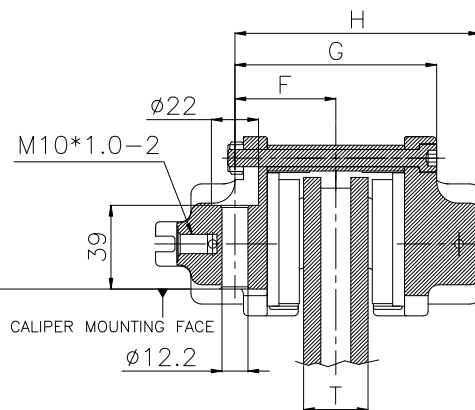
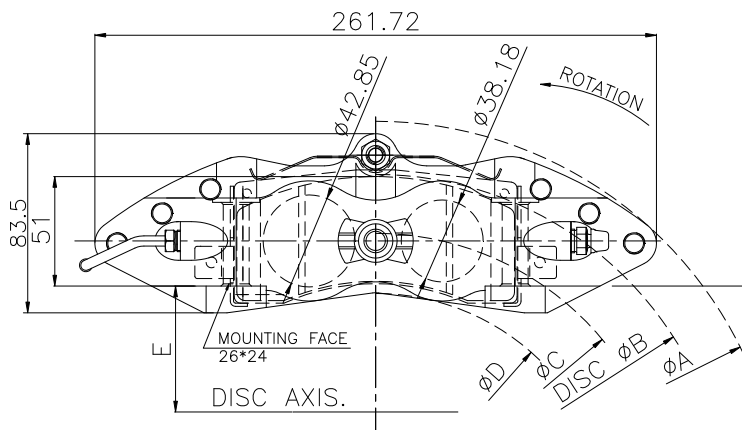

unit:mm

